

C. 717. 266

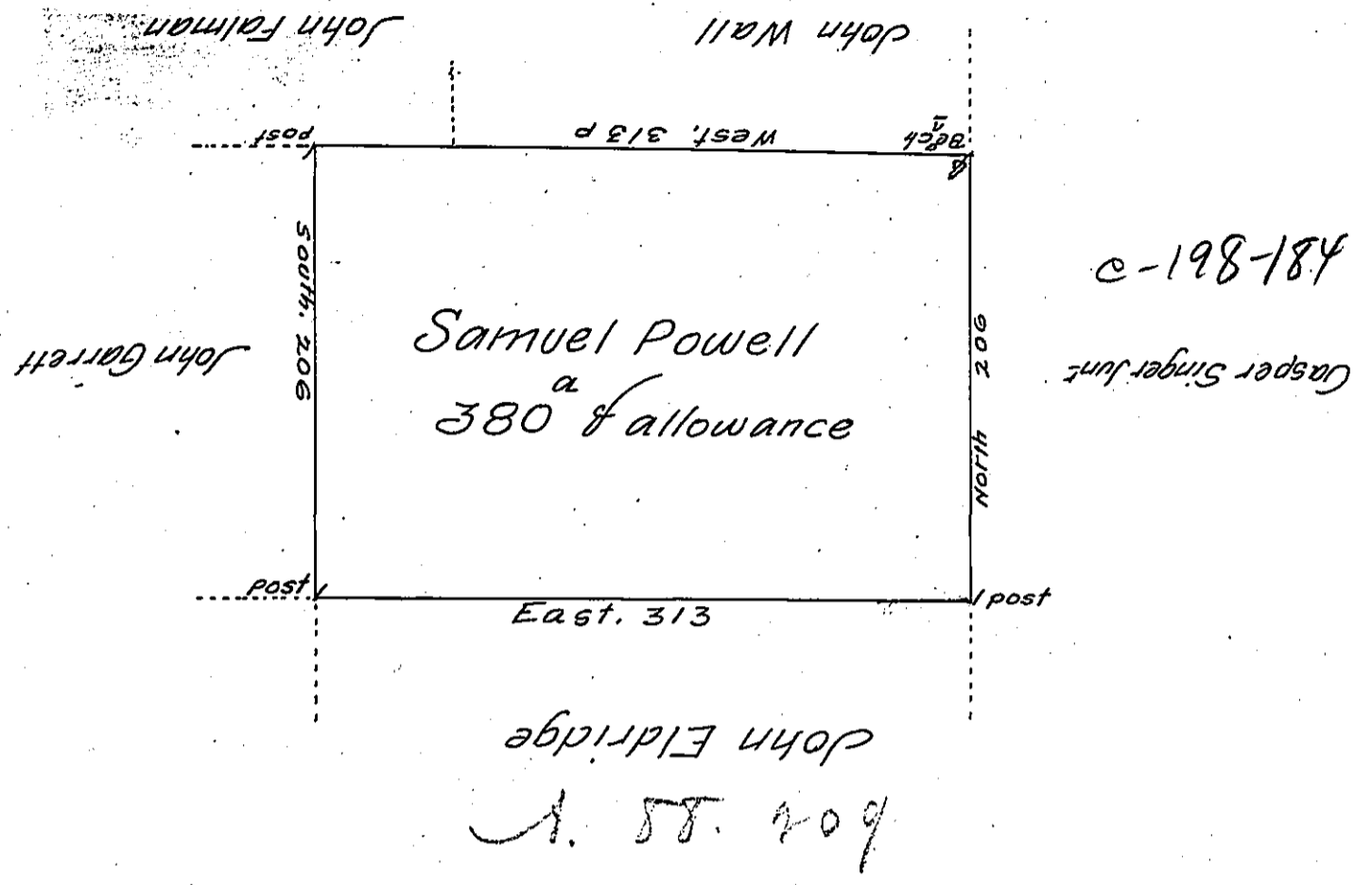

A Draught of a Tract of Land Called—situate adjoining
 Land of John Eldridge and others in Stoke Township and
 County of Northumberland, Survey'd on the 23^d day of Septem^r
 1786 for Samuel Powell by virtue of his Warrant bearing
 date the 18th day of July 1786 contain(ing) Three hundred
 and Eighty acres, with the allowance of six p Cent for roads &c.
 by W^m Gray D.S.

To John Lukens Esq^r
 Surveyor Gen^l

x now Luzerne

IN TESTIMONY that the above is a copy of the original remaining on file in
 the Department of Internal Affairs of Pennsylvania, made
 conformably to an Act of Assembly approved the 16th day of
 February, 1833, I have hereunto set my Hand and caused
 the Seal of said Department to be affixed at Harrisburg,
 this thirteenth day of June 1906

Geac D Brown
 Secretary of Internal Affairs.